

# JOHNNY ASTRO<sup>T.M.</sup>

# INSTRUCTION SHEET

Please Read These Instructions Carefully And Examine Contents For All Parts Before Assembly So That No Parts Are Discarded



© DE LUXE TOPPER CORPORATION, 1967 ELIZABETH, NEW JERSEY

## Step 1 Assemble Fan Head

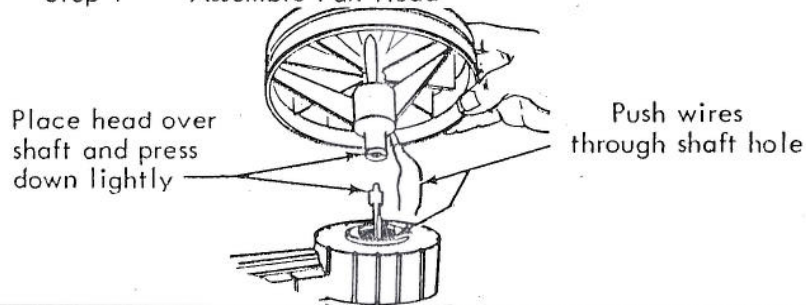

Turn base over and insert wires into clips

Red to Red Green to Green



Step 2 To install batteries, turn base over and insert batteries as shown. Be sure batteries are inserted correctly.

Step 3 Place launching station under fan base, lining up 3 holes with 3 posts. Be sure station is on the right side. See Step 7.

## Step 4 To Inflate Space Vehicle:

Blow up balloon until it just passes through the template (approximately 8" in dia.) and tie knot.

## Step 5 To Assemble Undercarriage:

Insert hook into slot

Outside to inside with this hook.

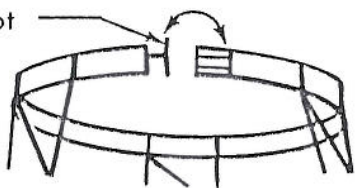

3 hooks from inside to outside

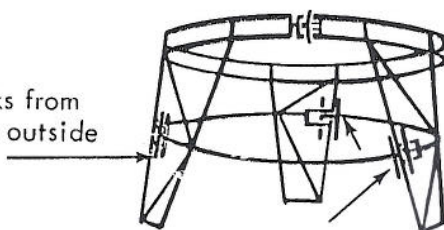

Template (Remove after inflating)

Tie Knot

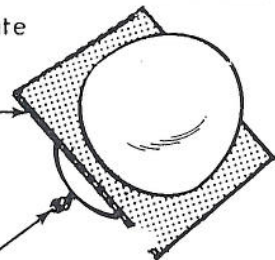

## Step 6 To Attach Undercarriage:

Scotch tape undercarriage to balloon at three points shown. Be sure to center around bottom of balloon.

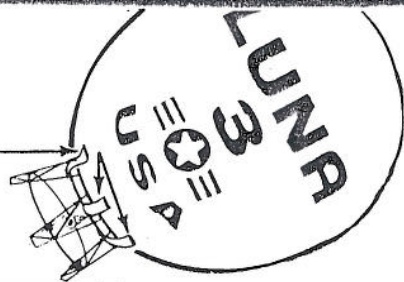

## To Attach Astronaut

Scotch Tape next to knot



## Step 7 To Operate Johnny Astro

**Directional Control**  
By moving directional control lever very slowly, you control direction.

**Altitude Control Lever**

By moving altitude lever very slowly forward and back - ward, you control distance.

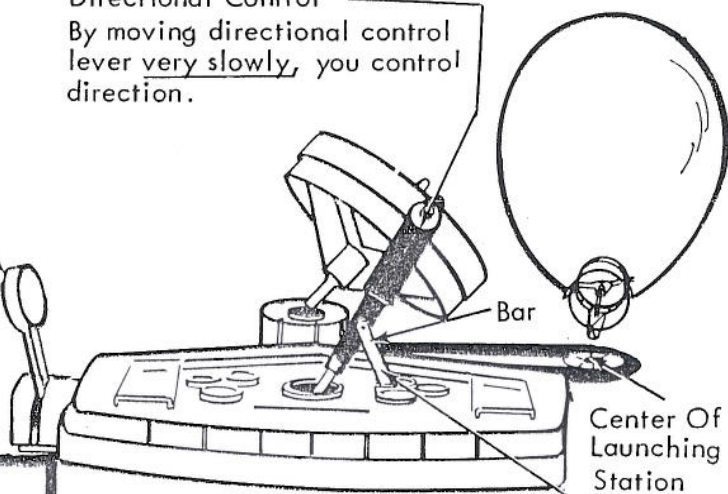

**Directional Control In Place Using Bar.**  
(Point Fan Directly At Space Vehicle Using Directional Control.)

## TAKE OFF AND LANDING

Place a space vehicle in the center of the launching station. Move directional control handle so that fan head is pointing directly at the space vehicle:

Move altitude control very slowly forward until space vehicle takes off. Move directional control very slowly to control direction. (Note - If take-off is difficult, set directional control in place using bar as shown. Very slowly advance altitude control and vehicle will take-off). **JOHNNY ASTRO CAN BE CONTROLLED EASILY BUT ONLY IF BOTH CONTROLS ARE MOVED VERY SLOWLY. IF CONTROLS ARE MOVED TOO FAST, YOU WILL LOSE CONTROL OF THE VEHICLE.**

Your space vehicle may land on the launching station or any surface that is at least 12 inches higher than the control base. Vehicle may be controlled within a distance of 3 to 4 ft..

### LIST OF PARTS

- 1 Control Base Assembly
- 1 Fan Head Assembly
- 1 Launching Station
- 3 Space Vehicles (Balloons)
- 1 Space Vehicle Template
- 2 Space Vehicle Undercarriages
- 1 Astronaut (Capsule)

For Additional Fun, Buy The Johnny Astro Moon And Mars Landing Base Set No. 6091

Part No. 6090-0010-B

PRINTED IN U.S.A.

Ordinary balloons may be used provided they are approximately the right size and shape but may not perform as well.

For a set of six extra Johnny Astro balloons, send \$.25 plus \$.25 handling charges (total \$.50) and the coupon at the right to:

De Luxe Topper Corp.  
Customer Service  
107 Trumbull St.  
Elizabeth, N.J. 07206

ABOUT 10 MINUTES PRACTICE IS REQUIRED TO OPERATE JOHNNY ASTRO WITH SKILL.

### PLEASE TYPE OR PRINT

From: De Luxe Topper Corp.  
Customer Service  
107 Trumbull St.  
Elizabeth, N.J. 07206

To: \_\_\_\_\_  
Address: \_\_\_\_\_  
City \_\_\_\_\_ State \_\_\_\_\_ Zip \_\_\_\_\_  
Code.